

801-D-108

PART NO

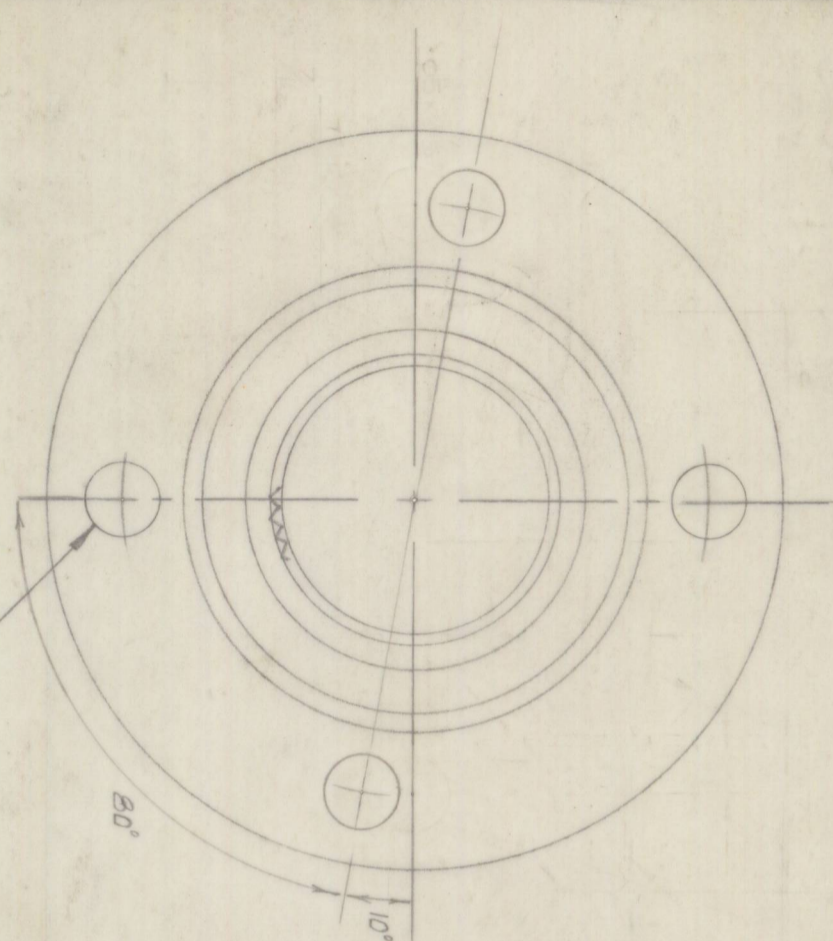

4 HOLES  $\cdot 3745$  DIA.  
ON  $3.125$  P.C.D.  
 $\pm$  WITHIN  $\cdot 004$ " OF  
TRUE POSITION

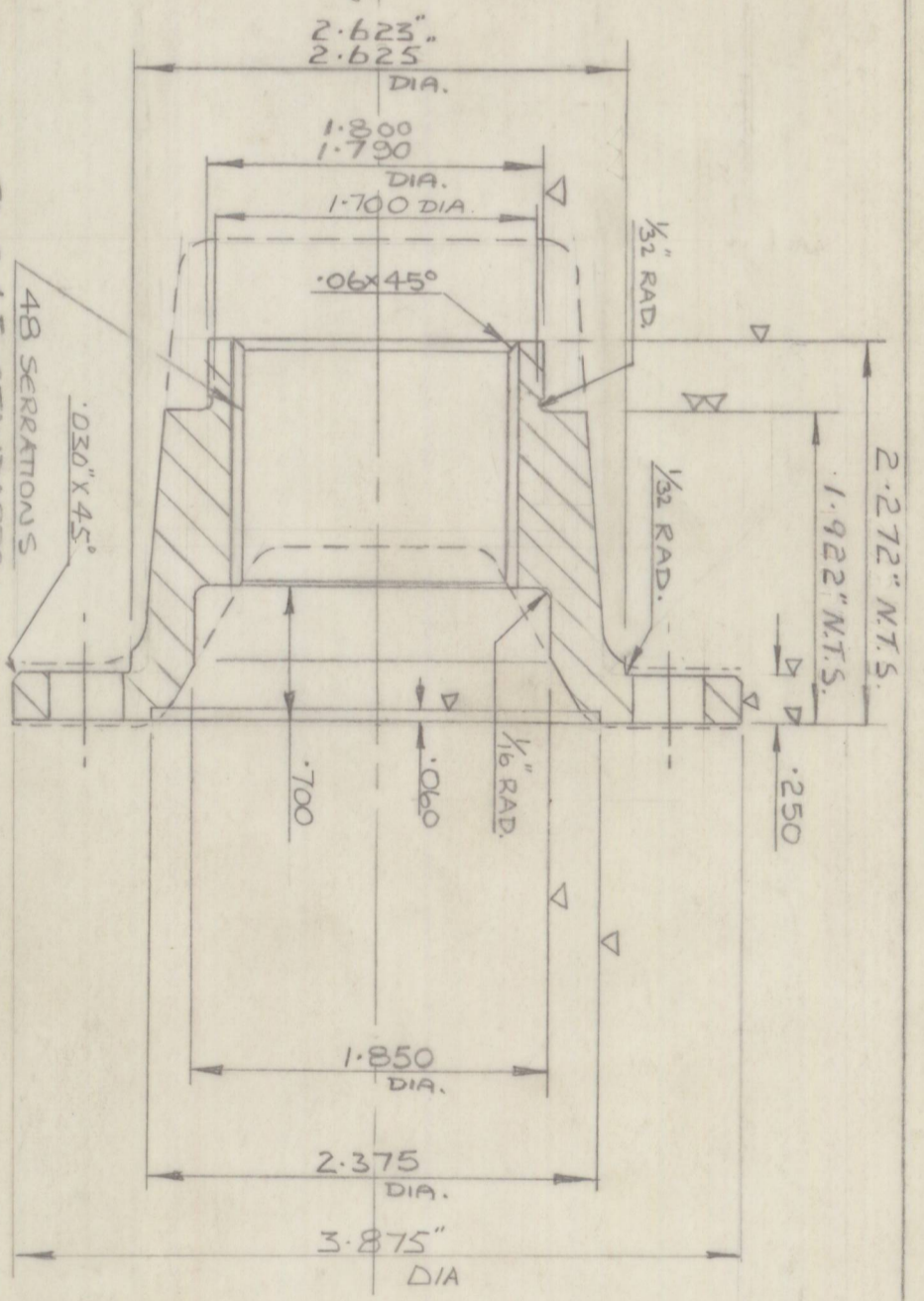

48 SERRATIONS  
TO S.A.E. STANDARDS  
MAJOR DIAMETER - 1.500 MIN. MINOR DIA - 1.426  
NOTE - ALTERNATIVE SPLINE TO SAE STANDARDS - MAJOR DIA:  $1.376$  MINOR DIA - 1.250  
WIDTH OF TOOTH -  $\cdot 2150$

NOTE - BROKEN LINE SHOWS OUTLINE OF FORGING  
 $\nabla$  - MACHINE  
 $\nabla\nabla$  - FINE MACHINE

SERRATIONS ON THIS PART TO BE MATCHED WITH THOSE ON O'BD DRIVE SHAFT AND 1.988 DIA. TO BE FINISH GROUND IN CONJUNCTION WITH O'BD DRIVE SHAFT

- BOWEN LIMITED -		SCALE FULL SIZE	LIMITS (UNLESS STATED OTHERWISE)
PLUCAS	DRAWN		$\pm .005$
5-9-67	DATE	MATERIAL	MAKE FROM HARDY SPICER FORGING NO FK2.1.GB19
1	ISSUE	HEAT TREATMENT	
	DETAILS		

NEW DRG.

TITLE COMPANION FLANGE - O'BD DRIVE SHAFT

MDD N°

PART N°

3-D-108